



85 The Esplanade Cronulla NSW

 4  4  4

PRIME OCEANFRONT POSITION WITH PANORAMIC WATERVIEWS

Embracing a coveted absolute oceanfront position this low maintenance home epitomises the ultimate seaside lifestyle.

With direct access to The Esplanade and capitalising on uninterrupted panoramic water views extending from Boat Harbour over the pristine bay and through to Jibbon Beach. This prized address is guaranteed to suit both persons who are upgrading and those downsizing but wanting to maintain a prestige and unique property.

- Immaculate presentation and well appointed inclusions
- Sun filled interiors with expansive views
- Formal and informal living areas
- Large entertaining terrace overlooking the bay
- Two fully self contained levels
- Private low maintenance yards
- Huge four car garage

Type : House
Land Size : 630 sqm
View : <https://www.brookes.net.au/sale/nsw/sutherland/cronulla/residential/house/5755980>

Jon Brookes
 m: 0416 069 169
 o: 9544 5555
 e: jb@brookes.net.au

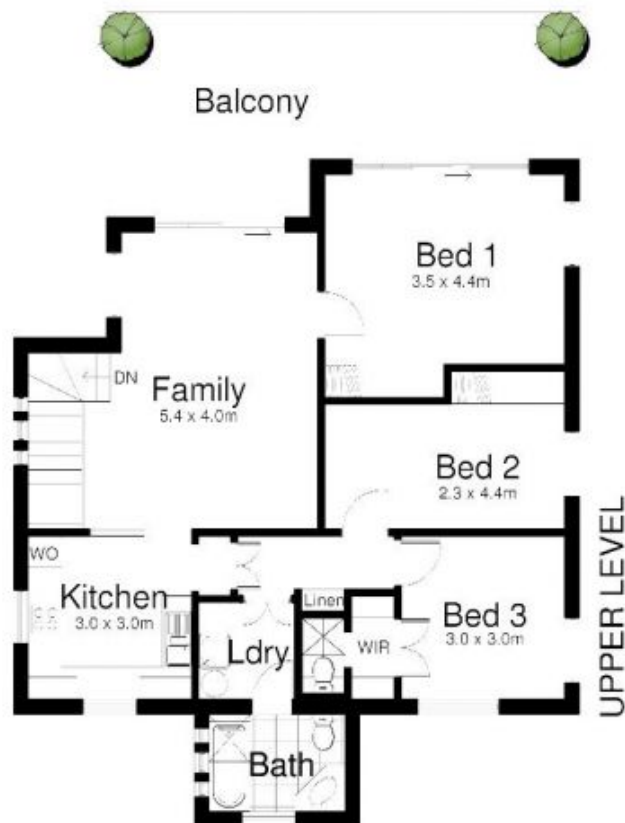

85 The Esplanade, CRONULLA

DISCLAIMER: All care has been taken in preparing this floorplan, however the accuracy is not guaranteed and no liability will be accepted for any reliance placed upon it
 Produced by PRODUCT PHOTOGRAPHY STUDIO mob: 0414 697 215 email: mgphoto@people.net.au